

USER MANUAL

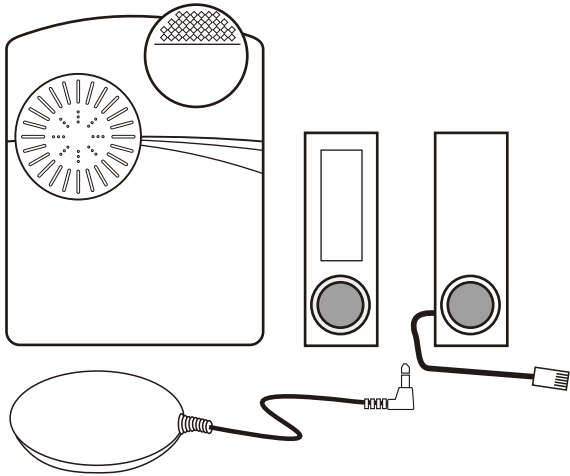

MAINTENANCE

- For best results, use good quality alkaline batteries.
- Always replace old or weak batteries.
- Keep doorbell dry. If wet, dry immediately.
- Do not use cleaning solvents on electronic products.
- Solvents contain chemicals that can damage circuitry. Use damp towel or cloth to clean. Dry immediately.
- Do not expose the bell unit to rain or immerse in water. It is not water resistant.

If the device is operated using a mains adapter, only use the approved mains adapter. Do not use any other type of mains adapter.

WARNING

The manufacturer is not responsible for any radio or TV interference caused by unauthorized modifications to this equipment.

PARTS & FUNCTION DOOR BELL

Receiver

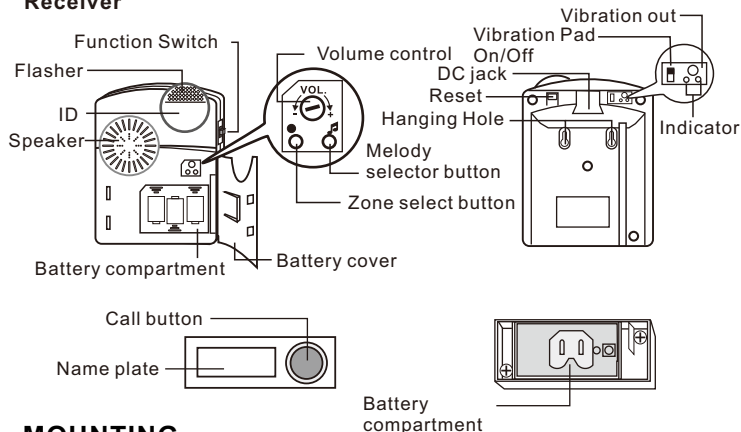

MOUNTING

Receiver

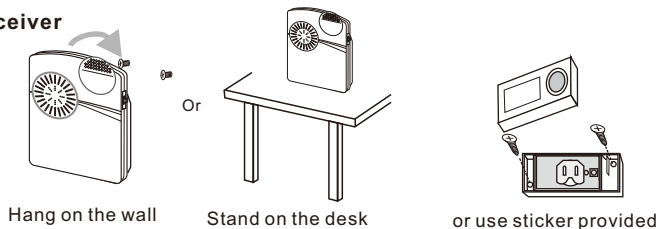

POWER

Receiver

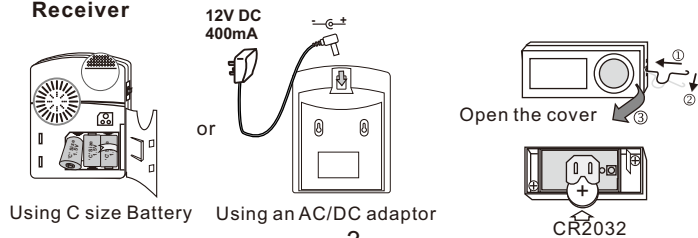

CODE PAIRING & MELODY SELECTION

PLEASE NOTE THE BELL PUSH AND CHIME ARE PAIRED AND READY TO USE.

Step 1: Insert battery to the transmitter to be used (bell push).

Step 2: Insert batteries to the receiver to be used (chime unit).

Step 3: Enter pairing mode for receiver (chime unit). Press and hold the ● zone Select button for 3 seconds. The LED #1 will flash.

Step 4: Press the ● button again to move to the zone you wish to pair with.

Press the 🎵 melody selector to scroll through the melodies. Once you hear your preferred melody, do not press again as it is now selected.

Step 5: Once the zone and melody are selected, press the bell push button once to pair. If successful, the receiver (chime) will generate a short tone. Press the ● button to exit pairing mode, the system is ready to use.

To stop the Chime whilst it is alerting press the reset button

Clear the transmitter on the Chime memory

First, press and hold the ● button for 3 seconds to enter the pairing mode. Press the ● button to move to the zone which is to be deleted. Press and hold the ● and 🎵 buttons together for 3 seconds.

The receiver will generate a tone to indicate the transmitter on this zone has been deleted.

Change the melody in desired zone

First, press and hold the ● button for 3 seconds to enter the pairing mode. Press the ● button to move to the zone then press the 🎵 button to select the melody required. Press the ● button until the pairing mode is exited.

Battery low indicator

If a zone LED light is blinking, it indicates that the battery is low for this transmitter. You must replace the battery as soon as possible. If the white flash at the top of the Chime blinks every 5 seconds, this indicates the receiver batteries are low. You must replace the batteries of the receiver.

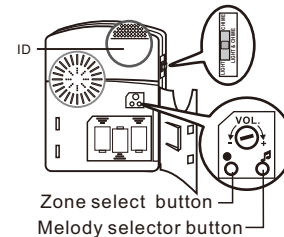

WIRELESS TELEPHONE SIGNAL TRANSMITTER

PARTS & FUNCTION BATTERY INSTALLATION

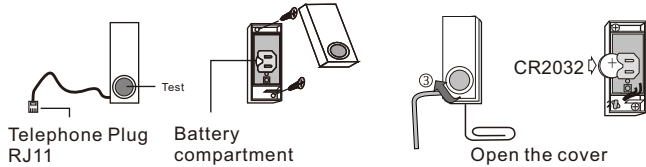

BATTERY LOW INDICATOR

The status of sensor battery is indicated on the receiver. Please refer to the "battery low indicator" on the receiver.

CODE CONFLICT

If the telephone signaler coding is the same as another sensor you must change the code. After you have changed the code re-matching the telephone signaler.

CODE MATCHING & MELODY SELECTION

The telephone signaler works with the receiver (chime or vibration) and must be paired prior to use.

Step 1: Insert battery to the telephone transmitter. ID

Step 2: Insert batteries to the receiver (chime).

Step 3: Enter pairing mode for receiver (chime unit). Press and hold the ● zone selector button 3 seconds. The LED #1 will flash.

Step 4: Press the ● button again to move to the zone you want to pair with.

Press the 🎵 melody selector to scroll through the melodies. Once you hear the telephone sound, do not press again as it is now selected.

Step 5: Once you have selected the zone and sound, press the test button on the telephone signaler once. If successful, the receiver will generate a short tone. Press the ● button to exit pairing mode it is now ready to use.

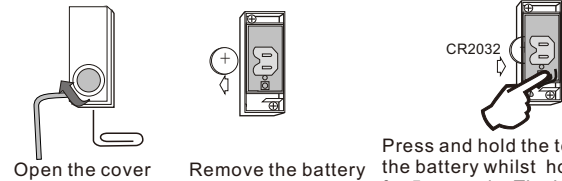
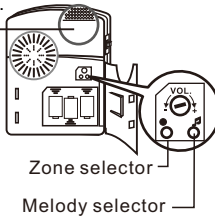

Press and hold the test button, insert the battery whilst holding the button for 5 seconds. The LED will flash 5 times when a new code is generated

OPERATION

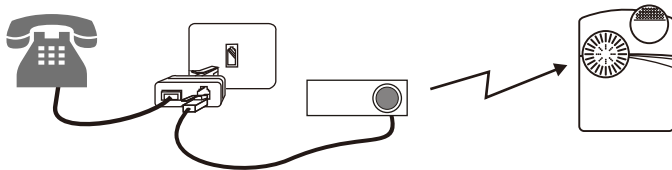

Plug the telephone line into the telephone socket as the diagram. The system is ready to use.



VIBRATION PAD

Part & Function

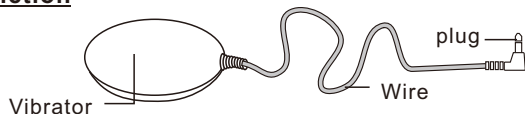

Setup

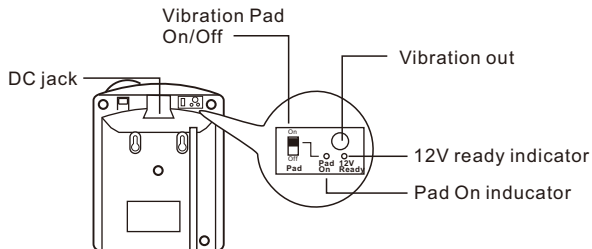

DC jack: If using the vibration pad, It must be connected a 12V 400mA AC/DC adaptor to this jack.

12V ready indicator: This indicator will lit up, when the 12V adaptor is connected correctly.

Vibration pad on/off: Slide this switch to turn on or turn off the vibration function.

Pad on indicator: If the Vibration pad on/off switch is slide to on position , this LED indicator will lit up to indicate Vibration function is ready.

Vibration out: Plug vibration pad to this jack.

FCC Statement:

This equipment has been tested and found to comply with the limits for a Class B digital device, pursuant to part 15 of the FCC Rules. These limits are designed to provide reasonable protection against harmful interference in a residential installation. This equipment generates, uses and can radiate radio frequency energy and, if not installed and used in accordance with the instructions, may cause harmful interference to radio communications.

However, there is no guarantee that interference will not occur in a particular installation. If this equipment does cause harmful interference to radio or television reception, which can be determined by turning the equipment off and on, the user is encouraged to try to correct the interference by one or more of the following measures:

- * Reorient or relocate the receiving antenna.
- * Increase the separation between the equipment and receiver.
- * Connect the equipment to an outlet on a circuit different from that to which the receiver is connected.

This device complies with part 15 of the FCC rules. Operation is subject to the following two conditions: (1) This device may not cause harmful interference, and (2) this device must accept any interference received, including interference that may cause undesired operation.

Note: Modifications to this product will void the user's authority to operate this equipment.

