

# USER MANUAL

Model: LD-3

## Part & Functions

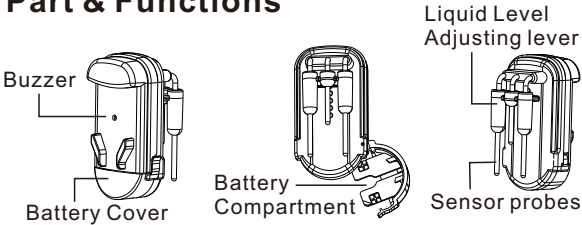

## Activate

To activate the unit, pull out the tag.

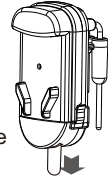

## Battery Installation and Replacement

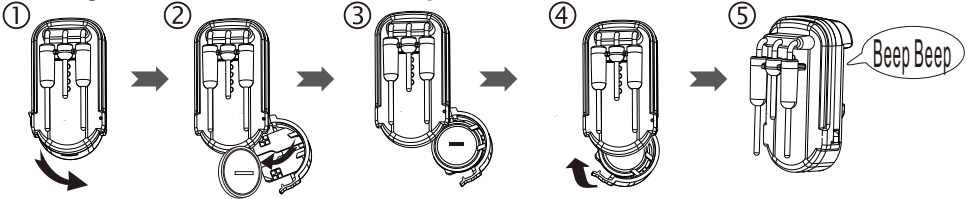

(1) Flip to open the battery cover, (2) Take out the old battery (3) Insert a new CR2032 battery cell to the battery compartment. (4) Flip to close the battery cover (5) The sensor will return two beep tone to indicate the battery is installed correctly.

## Operation

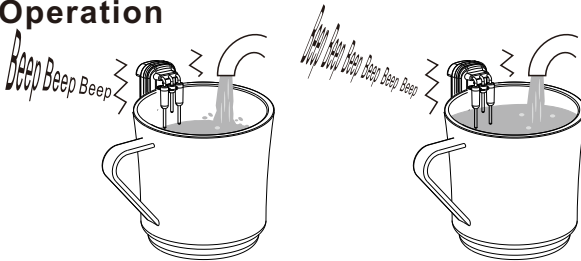

Hanging the sensor on the cup, add drinks, when drinks reach the level of the long probes (low liquid level probes), the buzzer will emit "beep..." sound and Sensor vibrates.

When levels reach short probe (High liquid level probe), beep sound and vibration will accelerate.

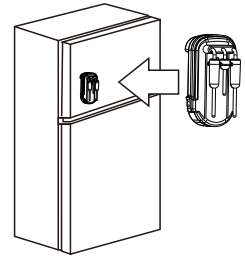

The sensor can be attached to the refrigerator or any any magnetic surface when not in use.

## Liquid Detection Level Adjust

Slide the level up and down to adjust the liquid level

